



Consumables for Kjellberg® HiFocus systems

PerCut 221M and PerCut 451M torches



Centricut consumables for the Kjellberg PerCut 221M and 451M deliver long life, fast cutting speeds, and excellent cut quality.

Lower cost

- Equal performance to Kjellberg Neo consumables, but at a competitive price.
- SilverLine electrodes and CoolFlow nozzles deliver exceptional cut quality and fast cutting speeds over the full life of the consumables.
- Local stocking and fast delivery reduce your inventory costs.

Easy to use

- No special system set up required.
- Centricut consumables fit all versions of the PerCut 221M and PerCut 451M torches.
- Patented keyless nozzle design provides better performance and improved cooling around the orifice and o-ring.

Upgrade to a better cutting experience with Centricut products for your Kjellberg® HiFocus 80i/161i/280i/360i/440i Neo systems.

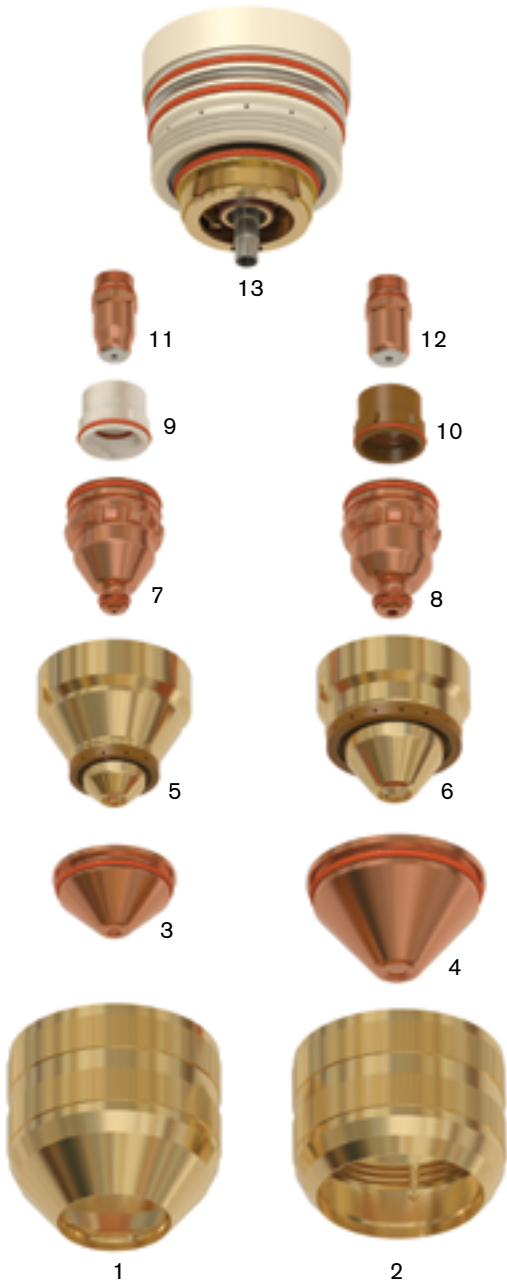

	Centricut part number	Reference number	Article number	Description
1	C124-981	G502	.11.852.201.081	Protection cap, 20-200 amp
2	C124-1981	G522	.11.852.401.081	Protection cap, 280-440 amp
3	C124-515	G4015	.11.848.201.1515	Swirl gas cap, 20 amp
	C124-520	G4020	.11.848.201.1520	Swirl gas cap, 60 amp
	C124-525	G4025	.11.848.201.1525	Swirl gas cap, 90-130 amp
	C124-530	G4030	.11.848.201.1530	Swirl gas cap, 90-200 amp
	C124-535	G4035	.11.848.201.1535	Swirl gas cap, 200 amp, Contour Cut
	C124-540	G4040	.11.848.201.1540	Swirl gas cap, 200 amp, Contour Cut
4	C124-550	G4350	.11.848.401.1550	Swirl gas cap, 280-360 amp
	C124-555	G4355	.11.848.401.1555	Swirl gas cap, 360 amp
5	C124-604	G3004	.11.848.201.1604	Nozzle cap, 20-35 amp
	C124-628	G3028	.11.848.201.1628	Nozzle cap, 60-200 amp
	C124-649	G3249	.11.848.401.1649	Nozzle cap, 280 amp
6	C124-609	G3209	.11.848.401.1609	Nozzle cap, 360 amp
7	C124-406*	G2006Y	.11.848.221.406	CoolFlow™ nozzle, 25 amp
	C124-407*	G2007Y	.11.848.221.407	CoolFlow nozzle, 35 amp
	C124-408*	G2008Y	.11.848.221.408	CoolFlow nozzle, 60 amp
	C124-410*	G2010Y	.11.848.221.410	CoolFlow nozzle, 90 amp
	C124-412*	G2012Y	.11.848.221.412	CoolFlow nozzle, 130 amp
	C124-414*	G2014Y	.11.848.221.414	CoolFlow nozzle, 160 amp
	C124-417*	G2017Y	.11.848.221.417	CoolFlow nozzle, 200 amp
8	C124-426*	G2326Y	.11.848.421.426	CoolFlow nozzle, 280 amp
	C124-430*	G2330Y	.11.848.421.430	CoolFlow nozzle, 360 amp
	C124-431*	G2331Y	.11.848.421.431	CoolFlow nozzle, 400 amp
9	C124-145C	G101C	.11.848.221.145C	Gas guide, low amperage and Contour Cut
10	C124-045	G121	.11.848.421.145	Gas guide, 280-400 amp
11	C124-1020*	G011Y	.11.848.231.320	SilverLine® electrode, 20-60 amp
	C124-1050*	G015Y	.11.848.231.350	SilverLine electrode, 90-160 amp
12	C124-1060*	G016Y	.11.848.231.360	SilverLine electrode, 200 amp
	C124-1310*	G092Y	.11.848.401.310	SilverLine electrode, 280 amp
	C124-1030*	G034Y	.11.848.421.330	SilverLine electrode, 360 amp
13	C124-1142	G902Y	.11.852.201.142	Cooling tube, 20-200 amp
	C124-042	G931Y	.11.848.401.142	Cooling tube, 280-400 amp

*Centricut part features a unique Hypertherm design that differs from the OEM design.

Technical support

Our product specialists can assist you with troubleshooting, optimizing your cutting process and questions on your Kjellberg plasma system

- We stand behind our products with industry-leading technical expertise
- Hypertherm-trained engineers and technicians on staff with over 50 years of combined cutting experience
- Free application support on all CNC plasma cutting systems

For more information on Centricut plasma products, visit www.hypertherm.com/centricutplasma

Hypertherm, Centricut, SilverLine and CoolFlow are trademarks of Hypertherm Inc., and may be registered in the United States and/or other countries. All other trademarks are the property of their respective owners. Hypertherm is in no way affiliated with Kjellberg.

One of Hypertherm's long-standing core values is a focus on minimizing our impact on the environment. Doing so is critical to our, and our customers' success. We are always striving to become better environmental stewards; it is a process we care deeply about.

© 9/2016 Hypertherm Inc. Revision 0
88149D



Hypertherm®
SHAPING POSSIBILITY™

